

THE VALLEY

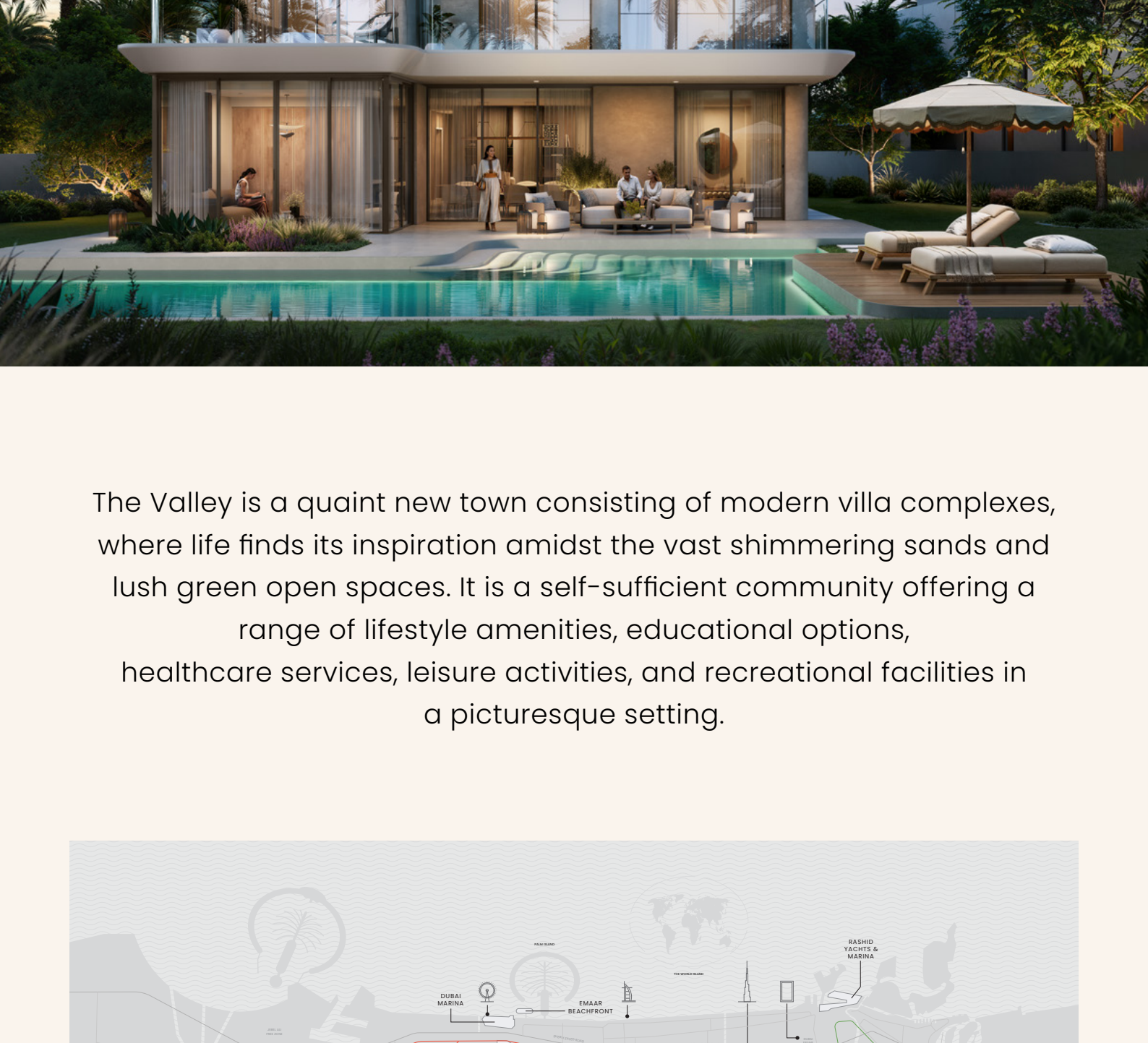

The Valley is a quaint new town consisting of modern villa complexes, where life finds its inspiration amidst the vast shimmering sands and lush green open spaces. It is a self-sufficient community offering a range of lifestyle amenities, educational options, healthcare services, leisure activities, and recreational facilities in a picturesque setting.



FARM GROVE
THE VALLEY

Where Life Thrives

Sprawling through the dotted greenery and shades of Ghaf trees, Farm Grove offers the ease of modern living in an elegant, self-sufficient community. Choose from villas, with personalised options like nature-inspired ambience, landscaped gardens and organic farming spaces.

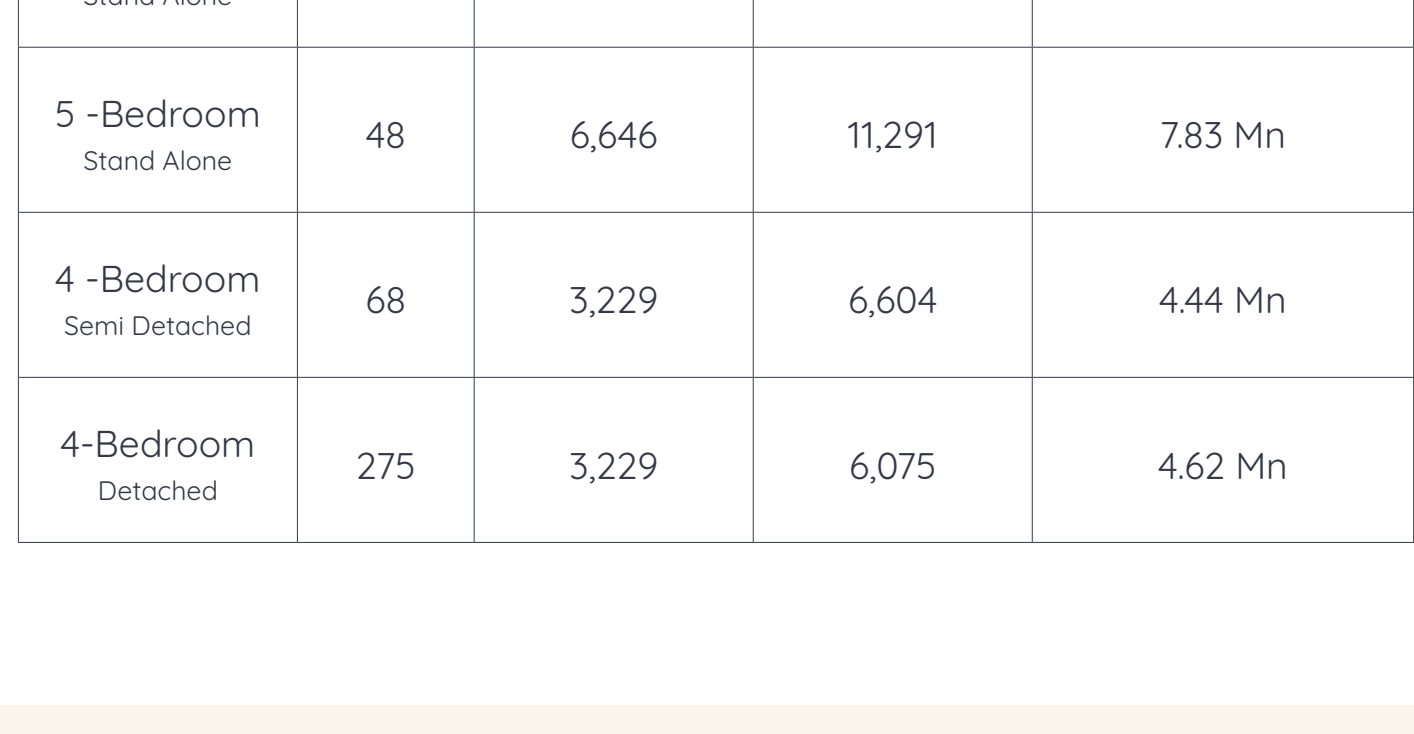

Residential Units

Villas	Units	Min. Plot Area (Sq. Ft.)	Max. Plot Area (Sq. Ft.)	Starting Price (in AED Mn)
4-Bedroom Stand Alone	91	5,081	8,736	6.68 Mn
5-Bedroom Stand Alone	48	6,646	11,291	7.83 Mn
4-Bedroom Semi Detached	68	3,229	6,604	4.44 Mn
4-Bedroom Detached	275	3,229	6,075	4.62 Mn

Homes where Luxury is Natural



A choice of 4 and 5-bedroom villas in varied yet unique contemporary designs

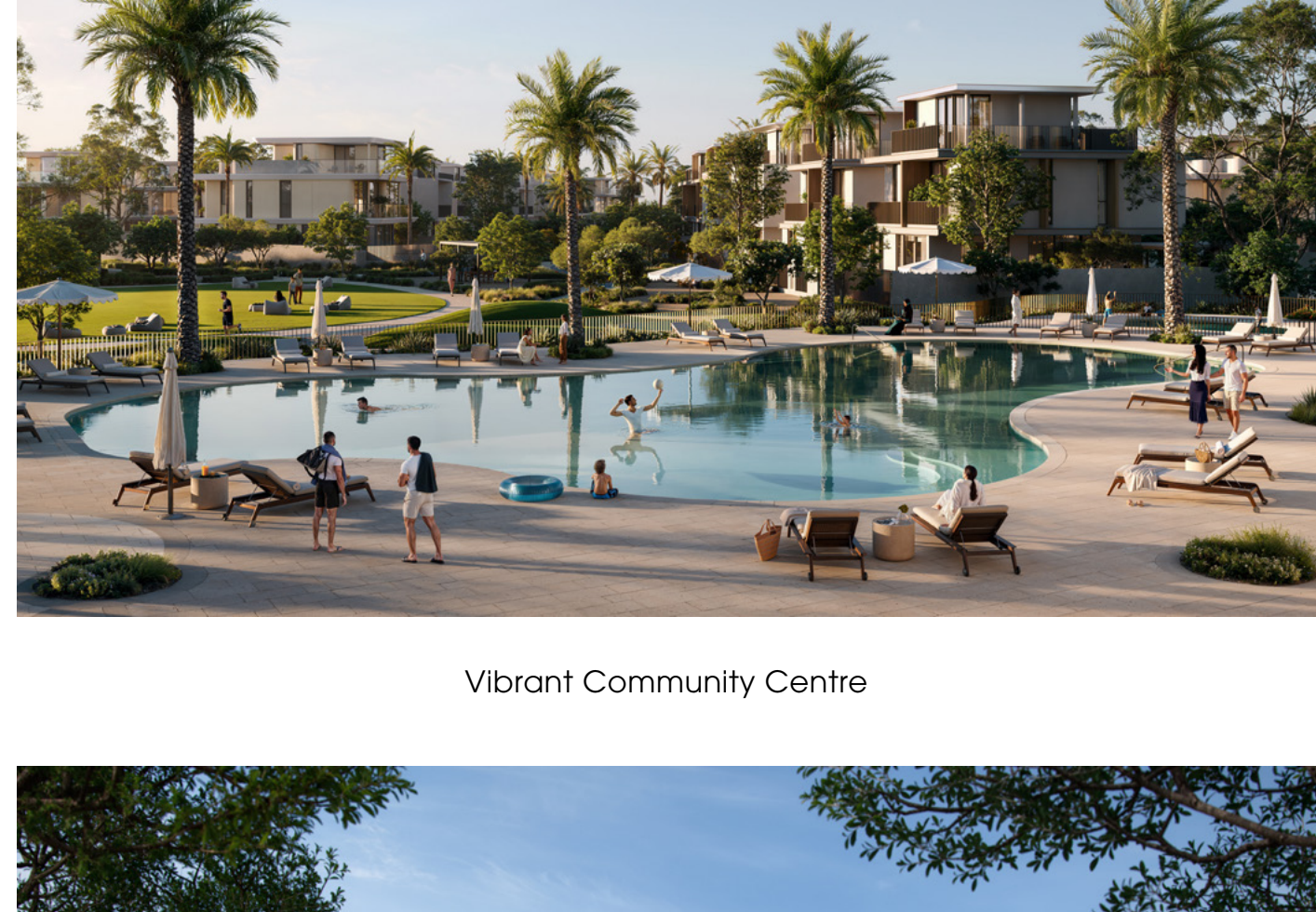
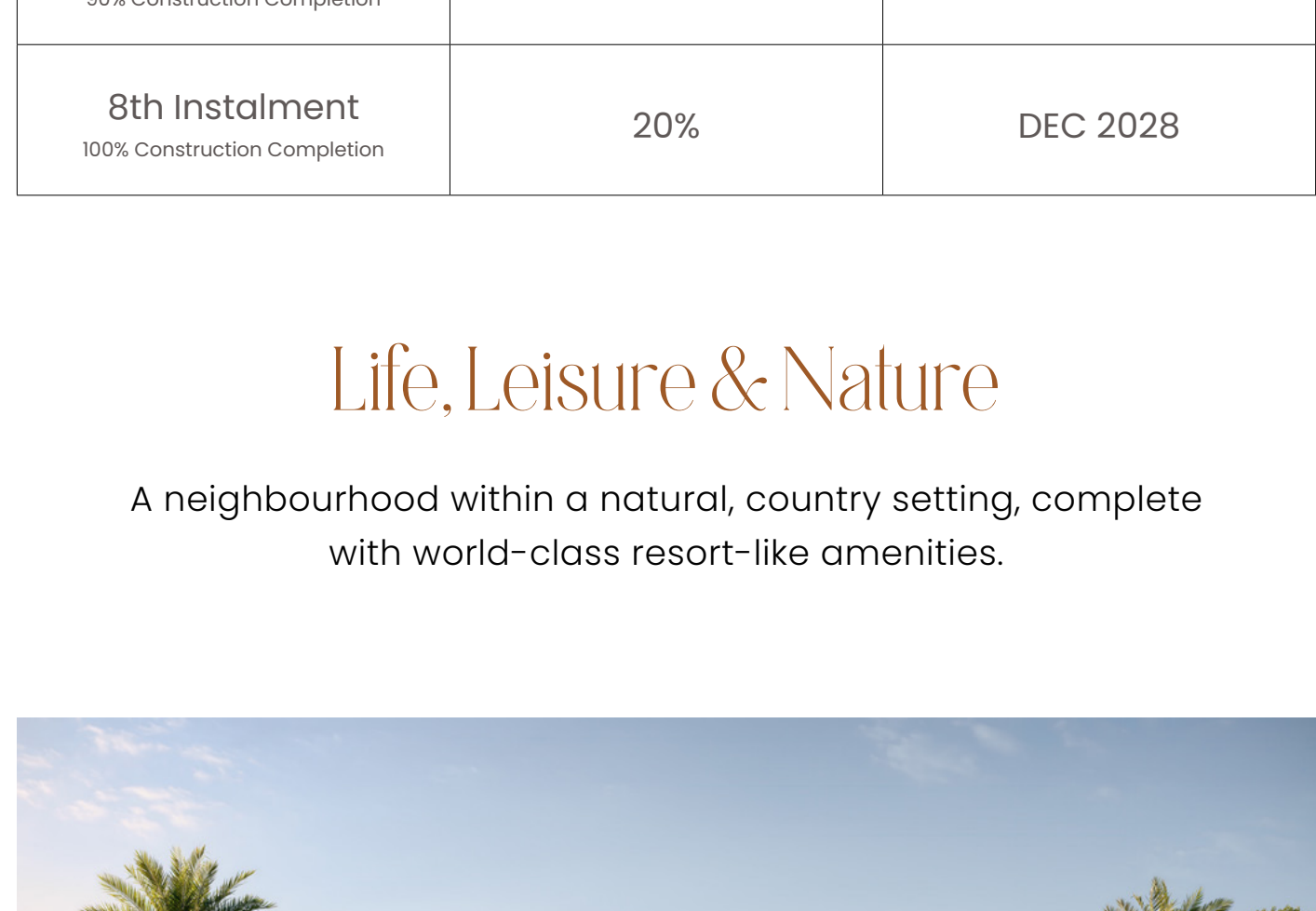

Payment Plan

Payment Plan	Payment Percentage	Date
Down Payment	10%	DEC 2024
1st Instalment	10%	FEB 2025
2nd Instalment	10%	JUL 2025
3rd Instalment	10%	JAN 2026
4th Instalment 20% Construction Completion	10%	JUL 2026
5th Instalment 50% Construction Completion	10%	MAR 2027
6th Instalment 70% Construction Completion	10%	AUG 2027
7th Instalment 90% Construction Completion	10%	FEB 2028
8th Instalment 100% Construction Completion	20%	DEC 2028

Life, Leisure & Nature

A neighbourhood within a natural, country setting, complete with world-class resort-like amenities.



Vibrant Community Centre



Pocket Parks & Playgrounds

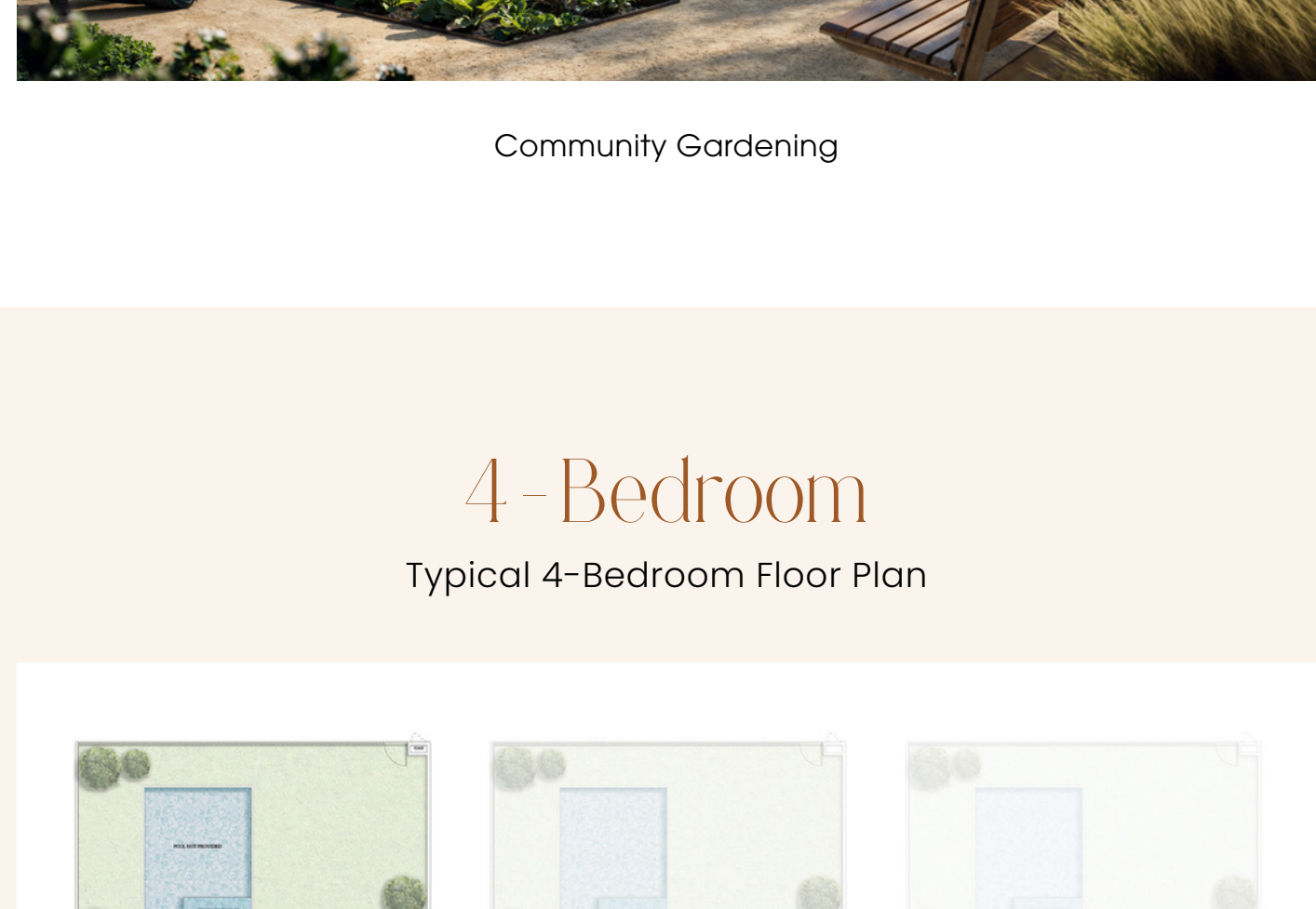

Outdoor Sports & Rejuvenation Spaces

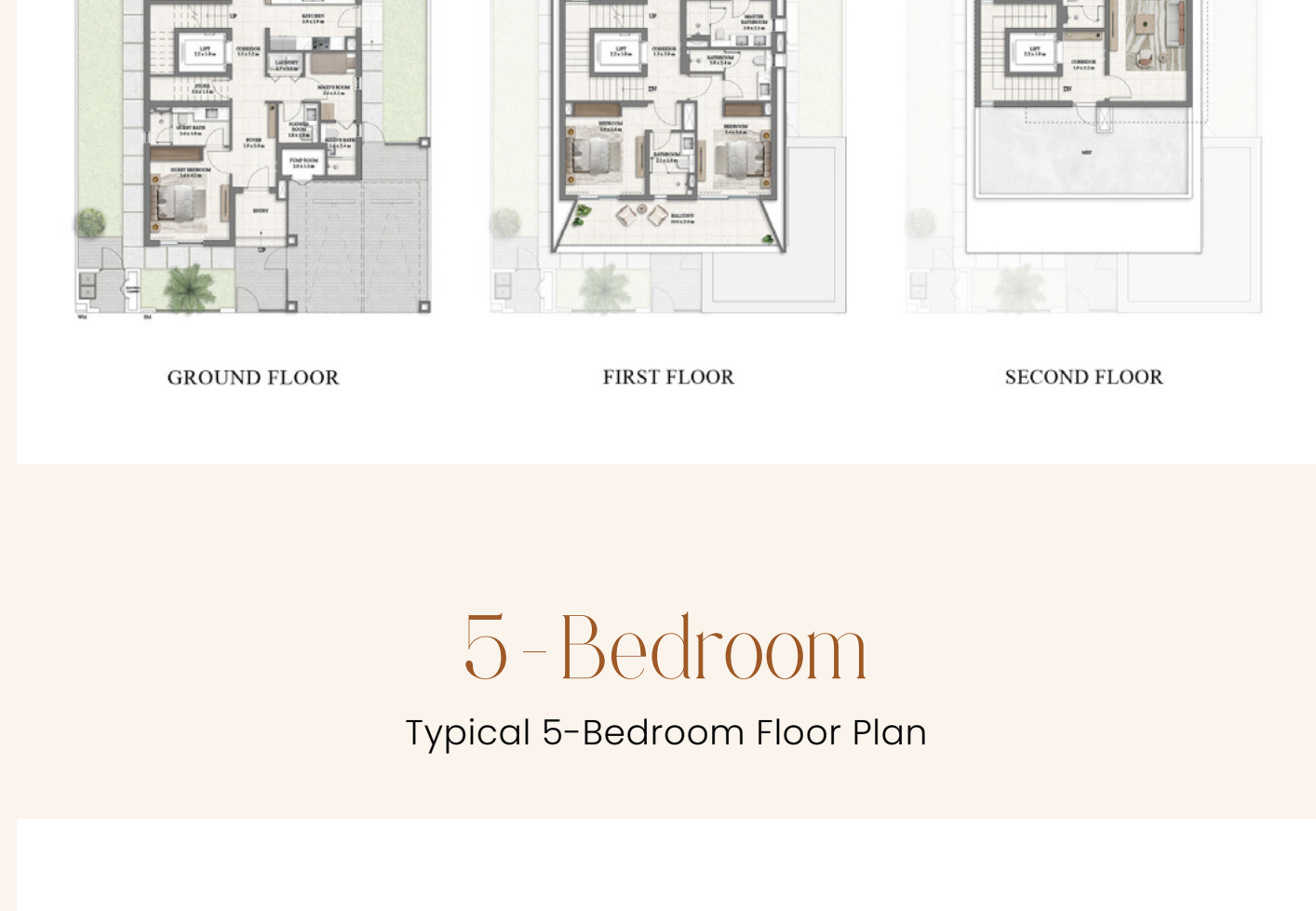

Community Gardening

4-Bedroom

Typical 4-Bedroom Floor Plan



5-Bedroom

Typical 5-Bedroom Floor Plan

